



**IDEAL SPACES,
PERFECT EVENTS**

Gleis21

THE IDEAL SOLUTION FOR YOUR EVENTS

SEMINARS / WORKSHOPS

BUSINESS EVENTS

PRODUCT PRESENTATIONS

BIRTHDAY PARTIES / WEDDINGS

CONFERENCES / LECTURES

CONCERTS / REHEARSALS

THEATRE / CINEMA

CHOIR / DANCE / YOGA



WELCOME!

WELCOME TO GLEIS 21!

With flexibility at its core, our versatile spaces allow for a variety of occasions and functions: be it corporate events, conferences, workshops or film screenings. Our professional cinematic equipment provides the perfect audio-visual backdrop for your successful event.

Thanks to its sophisticated acoustics, the space is ideally equipped for concerts and theatre performances. For those who are looking for a place to celebrate, GLEIS 21 is the right place to be: the spacious hall is made for exuberant private events and wild, colourful children's birthday parties.

The fact that this versatile space could be realised was made possible thanks to the support of many individuals from all over Austria and beyond. A successful crowd-funding campaign brought the space and its vision to life. Passing on this viable support, cultural initiatives from the adjacent neighbourhood, district and city are able to use the cultural area for their initiatives.

And this is what we stand for: solidarity, openness and diversity. Sophisticated architecture, communal and solidary

housing, as well as a vibrant art and cultural scene in the multifunctional spaces of GLEIS 21. All this contained in a sustainable timber house right next to Helmut-Zilk-Park.

We welcome you to visit GLEIS 21 at Sonnwendviertel Ost. We look forward to seeing you! You'll be back again for sure. Your team at GLEIS 21



A SPACE FOR SUCCESSFUL TEAMWORK

Are you planning a seminar, conference or an interactive workshop? Are you looking for a special location for your company event? Easily accessible from the airport, within walking distance of the Viennese main railway station? A space whose audio-visual set-up is of the highest quality and all accompanied by a comfortable in-house guest apartment?

If yes, then the multifunctional space at GLEIS 21, set within a sustainable timber building, are your first choice.





FURNISHINGS

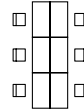

BLOCK

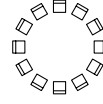

CIRCLE

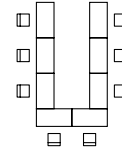

U-SHAPE

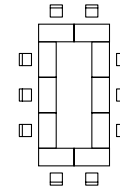

CARRÉ

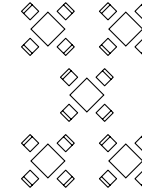

CAFÉ

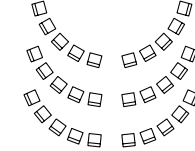

CURVED ROWS
OF CHAIRS



CINEMA

CATERING

Book our fully stocked coffee/tea trolley for short breaks between sessions. For your physical well-being and/or longer sessions or events, we recommend to book catering by the organic, in-house catering company 'Gaumenfreundinnen'. The restaurant 'Mimi im Stadtelefant', serving delicious lunch menus, is located just a few steps away. Self-catering is possible as well.

We are happy to assist your needs.

→ www.gaumenfreundinnen.com

→ www.facebook.com/Mimi.im.Stadtelefant



“

The wonderful acoustics at GLEIS 21 are one of the many reasons why workshops in this location are so pleasant and productive.

PLANSINN GMBH

”

**REQUEST AN
OFFER AND
BOOK NOW**

hello@gleis21.wien
+43 (0) 681 2084 5247
www.gleis21.wien

CULTURE: THAT'S US!

GLEIS 21 stands for art and culture as well as for communal living and neighbourly solidarity. We host concerts, theatre performances, film screenings, cabarets and readings in an intimate setting. The main hall accommodates a maximum of 96 seats, the stage is adjustable in height and variable in size. If desired, optional audio engineering support can be booked for your event.

GLEIS 21 - the right atmosphere for your function.



“

Small but oh! Great things are brought to life in this little gem of a place. Acoustically and atmospherically, the space offers everything needed for intimate interactions between musicians and their audience. We are lucky to have found this place!

THE STROTTERN

”



WE PROMOTE YOUR EVENT ...

- within the event section of our website
- on Facebook / Instagram
- on our event poster
- on our programme flyer
- in our Gleis 21 newsletter



REQUEST AN OFFER AND BOOK NOW

hello@gleis21.wien
+43 (0) 681 2084 5247
www.gleis21.wien

CELEBRATE, REHEARSE, MEDITATE

A yoga class, a choir rehearsal, perhaps a dance evening? Our space is suitable for lush parties, weddings or hosting events for kids, but also provides a tranquil space for silent retreats of mindfulness if required.

GLEIS 21 - a room suitable for all eventualities.





**REQUEST AN
OFFER AND
BOOK NOW**

hello@gleis21.wien
+43 (0) 681 2084 5247
www.gleis21.wien

“
*Our wedding
ceremony
was exactly
as imagined.
GLEIS 21 is
the best option*

*to host an individual celebration – without
pressure of time and at a great price – in
a modern, well-equipped room. Also, we’d
like to mention the very cordial and flexible
contact person who was always there for us
when needed.*

HANAN ABU EL-ENEIN

”



ROOM PLAN

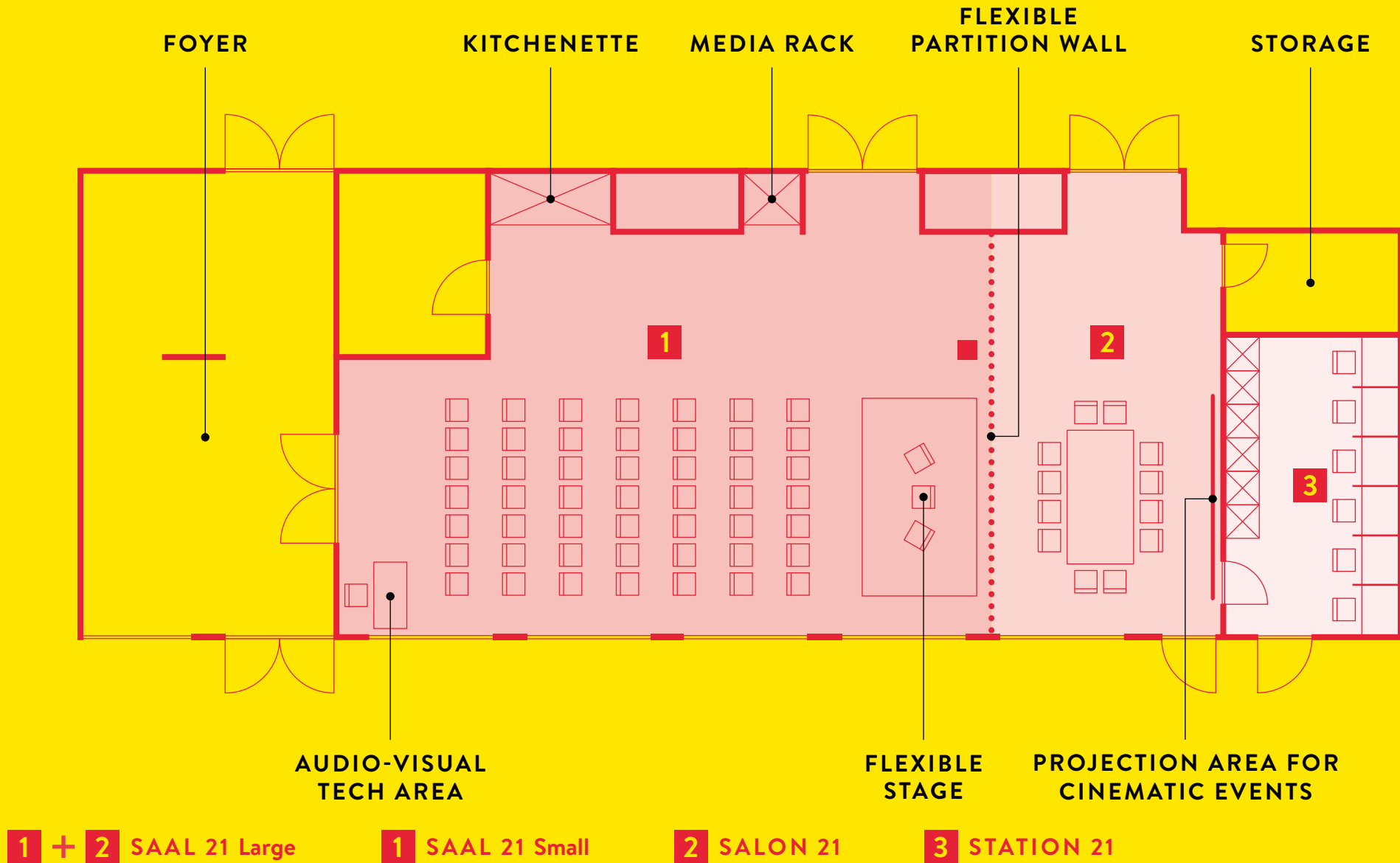



ROOM 21

- large 117 m² (max. 99 people)
- small 84 m² (max. 85 persons)
- associated backstage room (16 m²) located in the basement



SALON 21

- 33 m² (max. 14 persons)
- flexible partition wall opens up to ROOM 21



STATION 21

- 15 m² (max. 6 persons)
- Media room
- Backstage
- Workspaces

HIGH-QUALITY EQUIPMENT

- Bright, friendly rooms with daylight and wooden floors
- Acoustics suitable for seminars and concerts
- Flexible rooms and furnishings, well suited for interactive events
- High-quality audio-system / surround system / lighting console
- Great sound insulation
- Fast in-house WLAN
- Flexible stage (up to 18 m²)
- Blackout-system for cinema set-up
- Seminar equipment: projector, flip chart, pin boards, etc.
- Media room with individual workspaces
- Backstage rooms - located on the ground floor and in the basement
- Lockers for permanent tenants
- Kitchenette / catering
- Well ventilated (large windows to open, ventilation system)
- The rooms are at ground level and provide barrier-free access.

OUR GUEST APARTMENT

A guest apartment is located on the first floor and accessible via lift. In addition, the immediate vicinity offers a wide range of hotels for all budgets. A good night's sleep is guaranteed: our house is situated in a pedestrian zone right next to Helmut-Zilk-Park.



EASY TO REACH!

Our striking timber house is within eyeshot of the tram station Hlawkagasse (line D), right across Helmut-Zilk-Park, and within walking distance of Vienna's main train station as well as Keplerplatz (underground U1)

The adjacent bicycle and pedestrian bridge connects 'Sonnwendviertel East' with the green area of the Arsenal and the garden of Belvedere Palace..

-  Sonnwendviertel
-  Pedestrian zone
-  Railway area
-  Parking garage
-  Underground line U1
-  Tram line
-  Bicycle routes
-  Tram stops

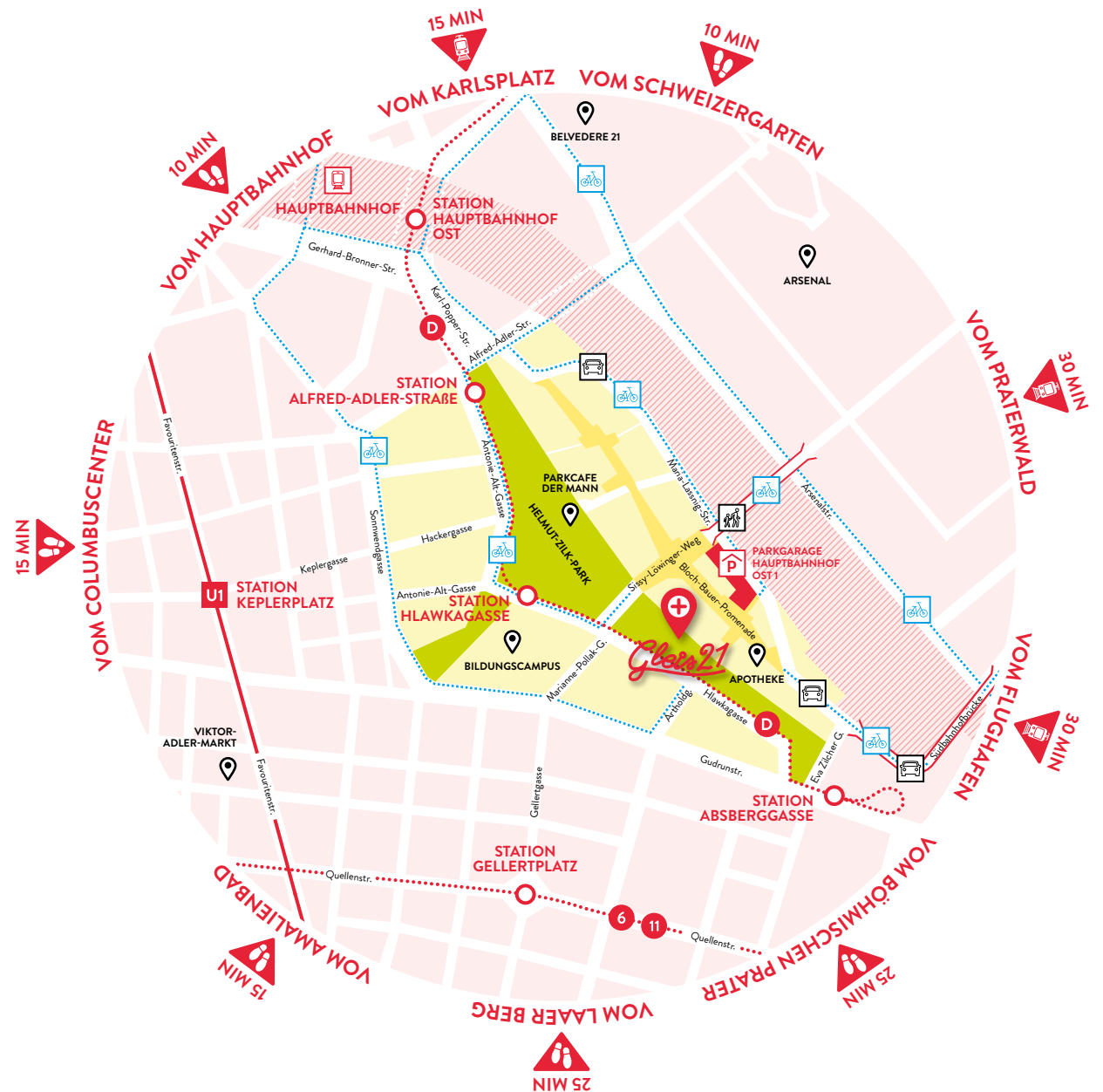



KLANGWERK

Our music school 'Klangwerk' at GLEIS 21 offers lessons in all common instrumental subjects as well as vocal coaching. The "Discover your Voice" and singing lessons take into account a wide variety of interests - be it as a means of creative expression or as classical voice training. "Elementary Music-making", ensemble playing in various formations and choral singing guarantee the joy of a collective musical experience!

Regular live concerts in the performance space of GLEIS 21 provide motivation and offer a real-life stage experience.

Last but not least: one of our most important concerns is to make our teaching offer accessible to children and adults alike.

Do you want to rehearse or practise on your own? Book Klangwerk's spaces outside school hours:

→ www.klangwerk.wien

toZOMIA

The art association 'toZOMIA' understands itself as a space and platform for the development and cultivation of resistant practices in art & life. As a venue for contemporary art and new urban ecologies, to exhibitions and numerous residencies for artists, the space serves as a meeting hub for local and international exchange. In the past, successful neighbourhood initiatives have been developed and taken place, such as 'The Sunday Shelf' and a Cargo Bike Market.

In the field of community building, the mobile Solar Manufactory, a part of Urban-FoodLab, draws attention to collective forms of energy-autonomous cooking events at the interface to public space.

The Kulturcafé 'Kaffeesatz' is a cosy coffee house embedded within the toZOMIA art association. Their offer includes excellent coffee specialities, regionally crafted baked goods and a daily special. Catering may be booked on request.

→ www.tozomia.net

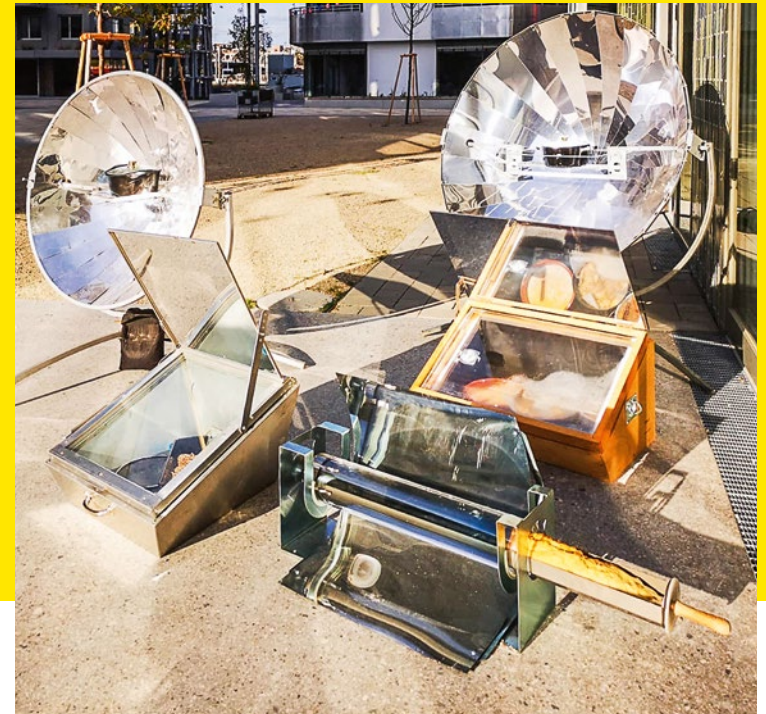



TOGETHER AS ONE

We at GLEIS 21 aim to create a sustainable living environment, to focus on social encounters and to live solidarity — within our own community and beyond. We strive to live within a lively community instead of an anonymous urbanity. In short: to create a village within a cityscape.

The meaningful and thought-through concept of the building's architecture enables us to do just that. It actively promotes community and creates a new sense of belonging. All residents — 50 adults as well as 30 children and young adults — are involved in shaping their sociocratically organised housing project.

GLEIS 21 is located in a recently developed district, the Sonnwendviertel, which forms a bridge between Vienna's 10th district and the inner city. It is important to us to provide a bridging function and complement the existing urban areas with a diverse, cooperative space in which many things can happen, a meeting space for all generations.





PHOTOGRAPHY

Hertha Hurnaus, Thomas Reibnegger,
toZOMIA, Maria Frodl

EDITORIAL

Margit Desch, Martina Handler,
Michael Kerbler, Monika Witzany

GRAPHIC DESIGN

grafische kooperative,
Thomas Reibnegger

Gleis21

GLEIS 21

Bloch-Bauer-Promenade 22
1100 Wien

hello@gleis21.wien
www.gleis21.wien

