



FREAKS 4U GAMING STUDIOS AV-PRODUCTION | CREW | EQUIPMENT



# WHO WE ARE & WHAT WE OFFER

Nobody knows the gaming and esports communities better than we do: marketing- and content-wise.

Our versatile team of TV professionals, journalists, editors and producers is expertly educated on the topics that concern the scene, the latest industry trends and developments as well as having the means to create truly sustainable digital productions. Convey our passion for gaming and esports to a young target audience is our daily business.

To fit the requirements for your brand in best possible way we build unique custom tailored set design. Our production crew has years of experience in broadcasts for TV, streams, live events and web formats.

STREAM SETUP FOR:



**TREAS 4U**  
GAMING







VCT EMEA 2022

**FREAKS 4U**  
GAMING



OVERTAKE NITRO NIGHTS 2020 - 2023



KAS GAMES & POLITICS 2022



NLC 2022



LEC 2022 - 2023



# PRODUCTION SPACES HALL 2

## Hall 2

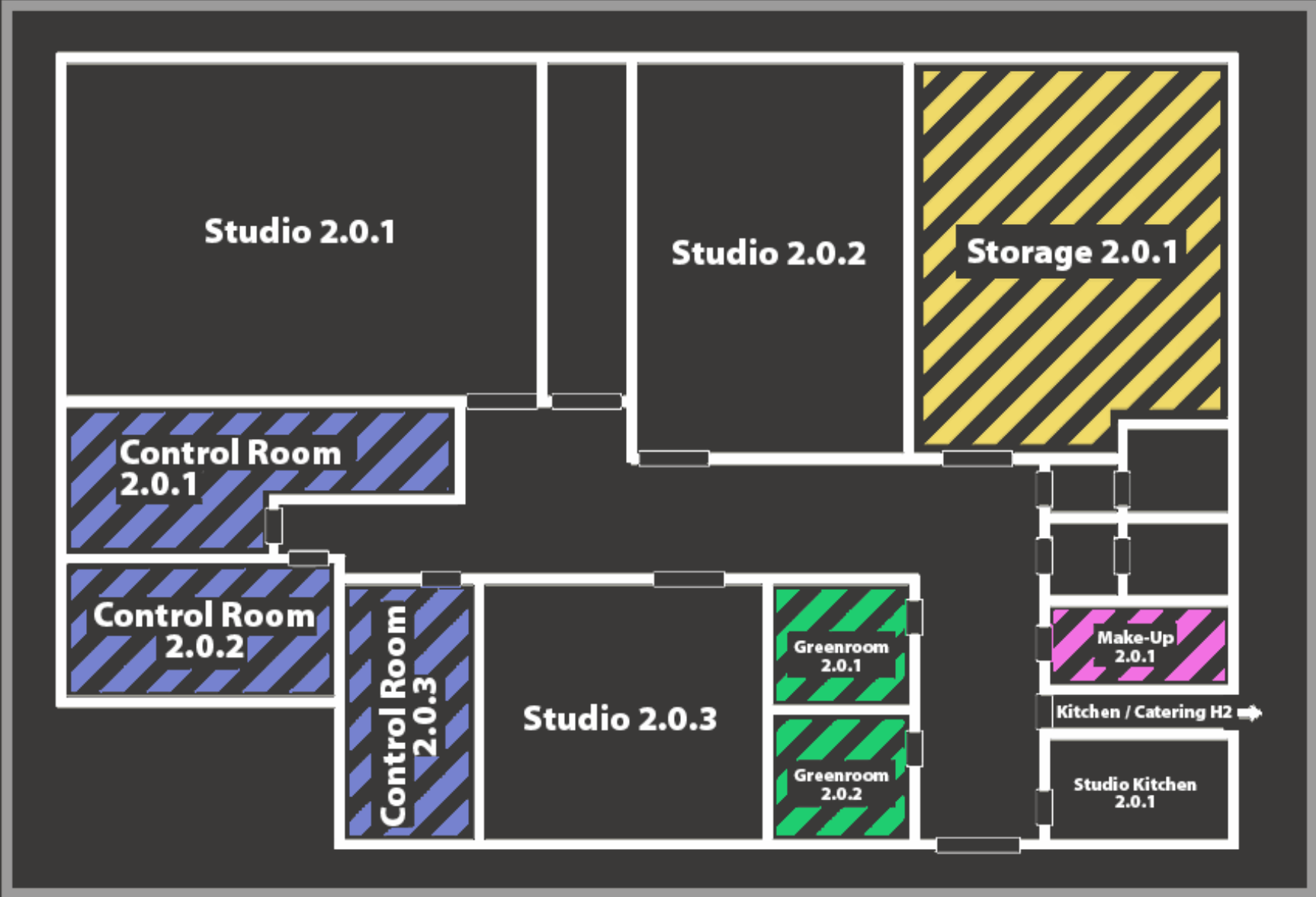

## Hall 2



TWITCH PREMIERE LAST ONE LAUGHING | STUDIO 2.0.1



PRIME LEAGUE | STUDIO 2.0.2



GAMESCOM TIKTOK | STUDIO 2.0.3





# STUDIO 2.0.1

Studio 2.0.1 is where your production dreams take center stage. Completed in 2020 and located in our state-of-the-art Hall 2 complex in Spandau, Studio 2.0.1 offers you all the creative freedom you need for any kind of production.

Studio Size: 16m x 12m | 192m<sup>2</sup> | Ceiling height of 3,67m

## FEATURES



professional  
audio



professional  
video



professional  
lighting



0db passive  
cooling system

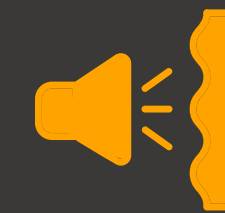

soundproof



fresh air



central signal  
management



uninterruptible  
power supply



customizable  
interior



3x3 monitor  
wall



OUR LARGE STUDIO WITH PLENTY OF SPACE FOR CREATIVITY



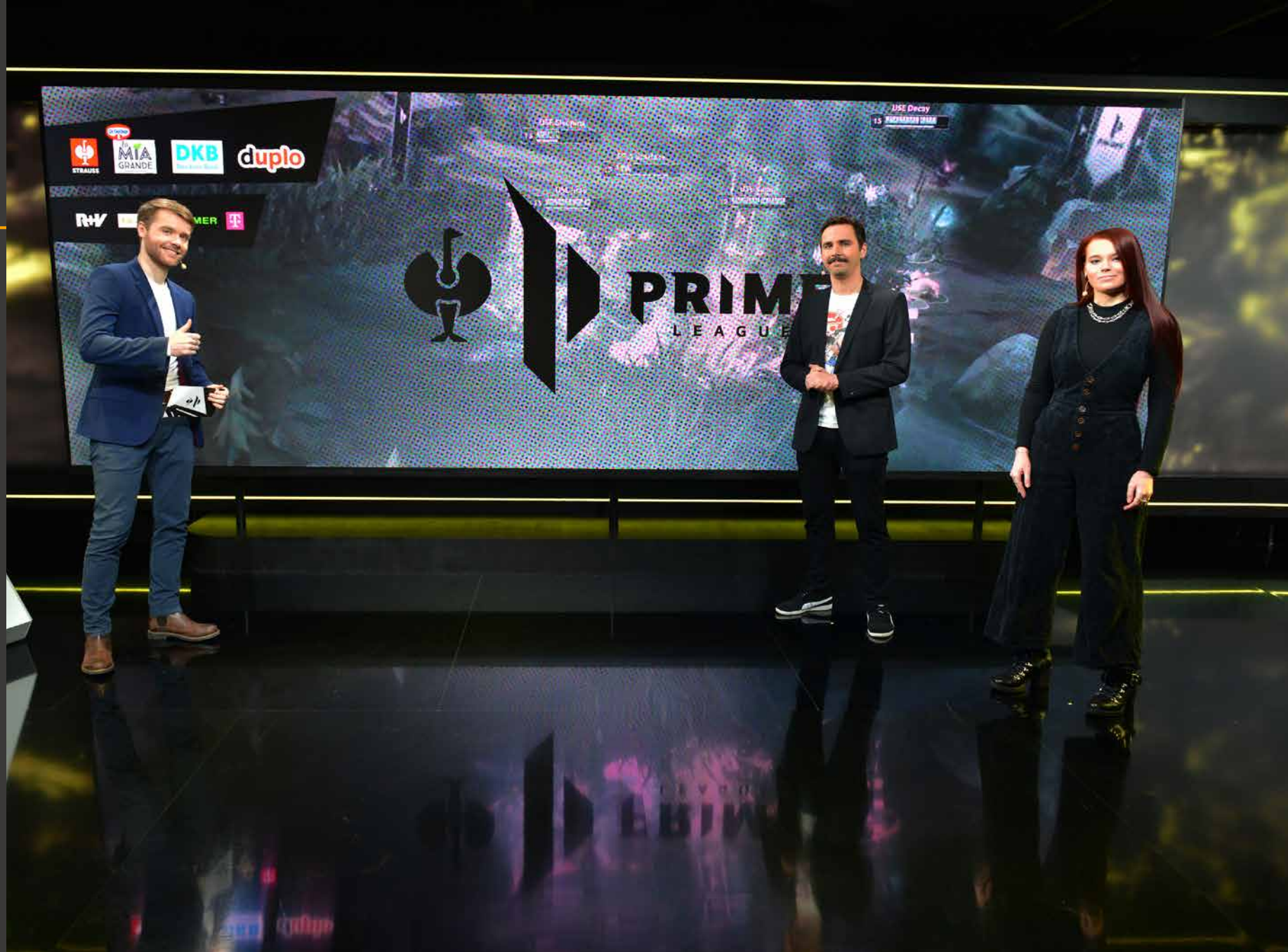

# STUDIO 2.0.2

Studio 2.0.2 is where your creative vision becomes reality. Completed in 2020 and located in our state-of-the-art Hall 2 complex in Spandau, Studio 2.0.2 is ideal for video production, set construction, and projects with intricate lighting and sound requirements.

Studio Size: 13m x 8,6m | 117m<sup>2</sup> | Ceiling height of 3,40m

## FEATURES



professional  
audio



professional  
video



professional  
lighting



0db passive  
cooling system

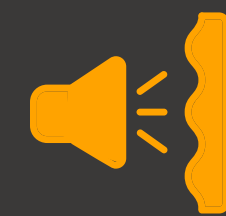

soundproof



fresh air



central signal  
management



uninterruptable  
power supply



background LED  
wall



customizable  
interior



highres LED  
wall



OUR MID-SIZE STUDIO WITH A 270° LED WALL





# STUDIO 2.0.3

Studio 2.0.3 may be our smallest space, but it's big on visionary possibilities.

Studio Size: 8,75m x 8,4m | 117m<sup>2</sup> | Ceiling height of 3,40m

## FEATURES



professional  
audio



professional  
video



professional  
lighting



0db passive  
cooling system

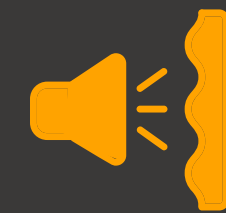

soundproof



fresh air



central signal  
management



uninterruptible  
power supply



customizable  
interior



SMALL AND CUTE





# STUDIO KITCHEN

Unleash your culinary creativity in our fully equipped Spandau kitchen studio, where you can showcase your skills, engage with a food enthusiast community, and enjoy seamless livestreaming or recording options in a professional broadcast environment.

WE ARE HERE TO MAKE YOUR CREATIVE CULINARY VISIONS REALITY!

## FEATURES



professional  
audio



professional  
video



professional  
lighting



cooling system

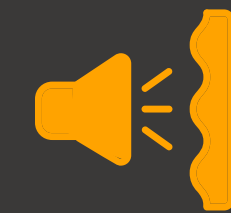

soundproof



fresh air



central signal  
management



uninterruptable  
power supply



standalone or  
crew



kitchen  
equipment







# CONTROL ROOMS

We've crafted three state-of-the-art control rooms in our Hall 2 studios, designed to meet your broadcasting requirements and ensure seamless and easy control of your production.

CONTROL ROOM 1: Space for up to 17 people

CONTROL ROOMS 2 + 3: Space for up to 12 people

## FEATURES



professional  
audio



professional  
video



redundancy



cooling system

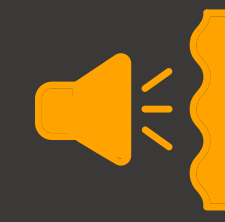

soundproof



fresh air



central signal  
management



uninterruptable  
power supply



scalable



remote  
production  
capabilities

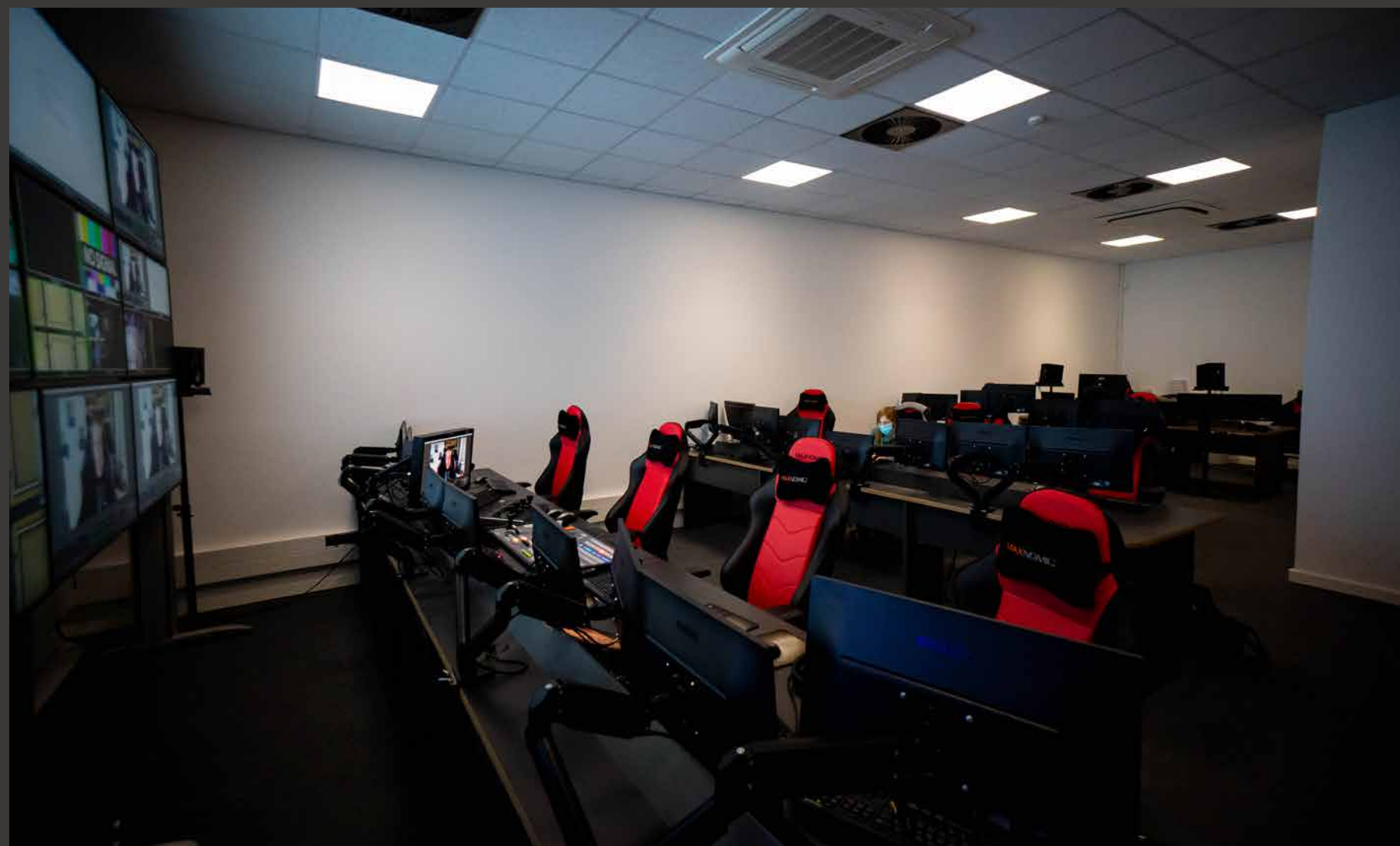



# PRODUCTION SPACES HALL 1

## 3. Floor

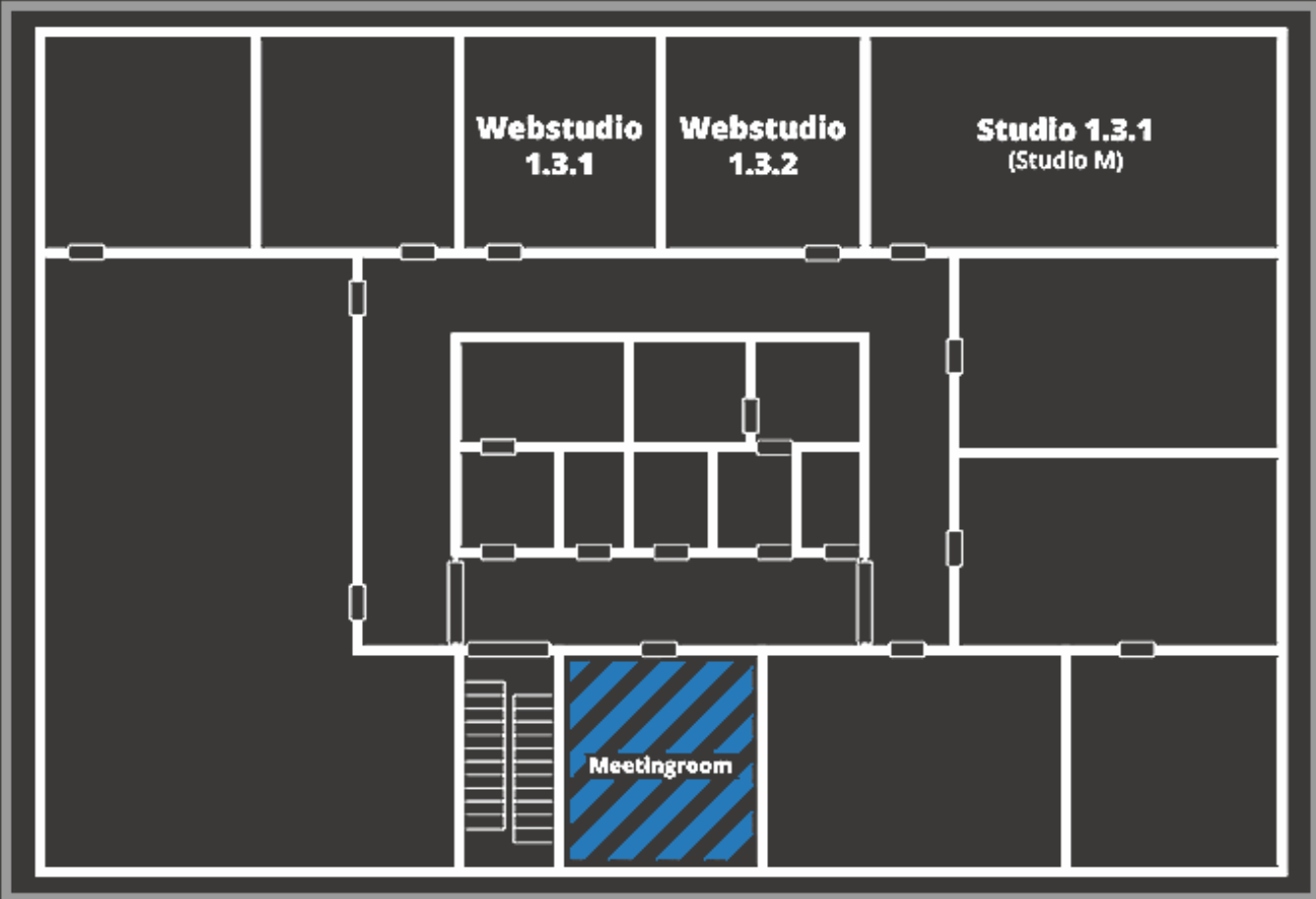

## 2. Floor

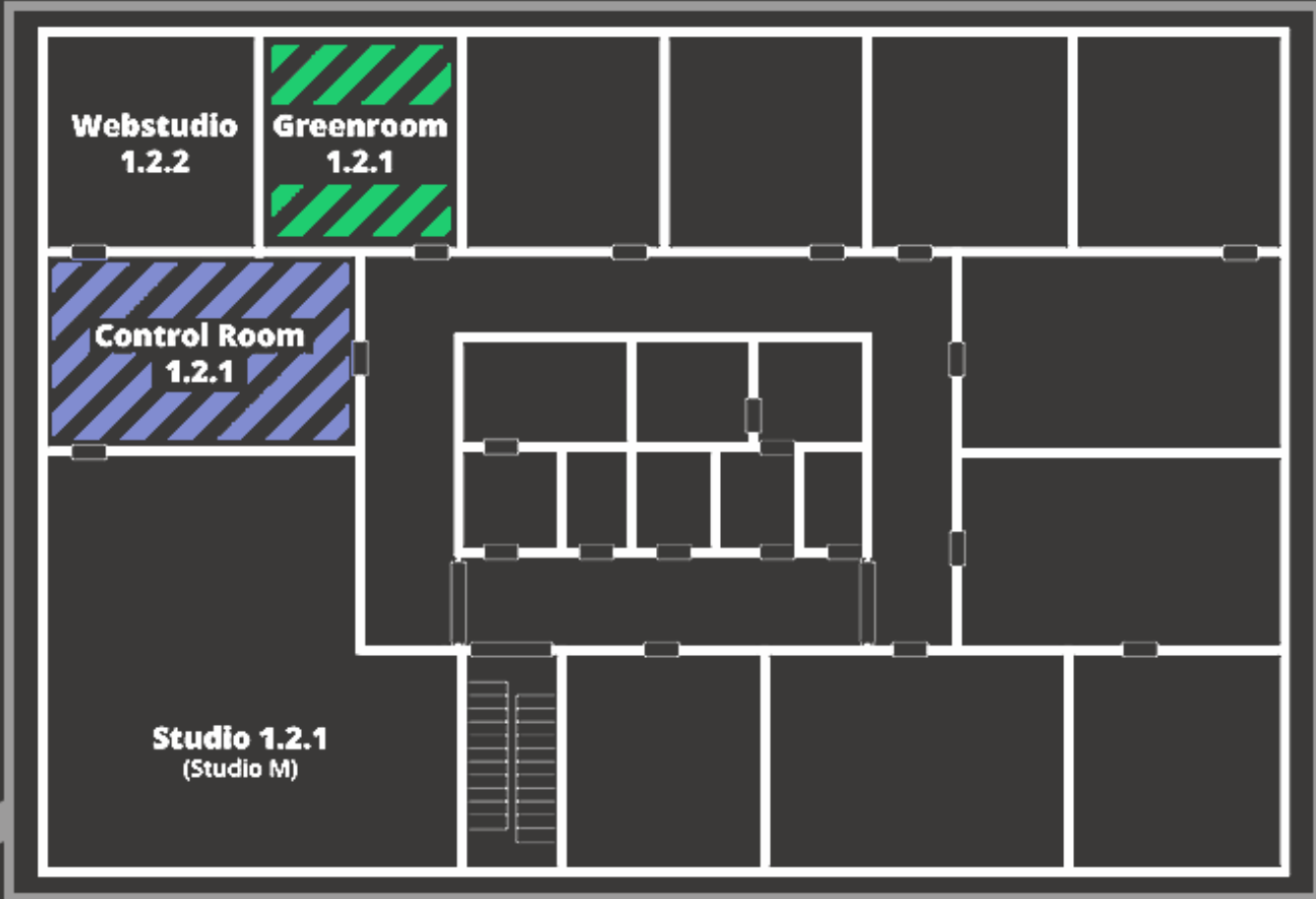

## Hall 1

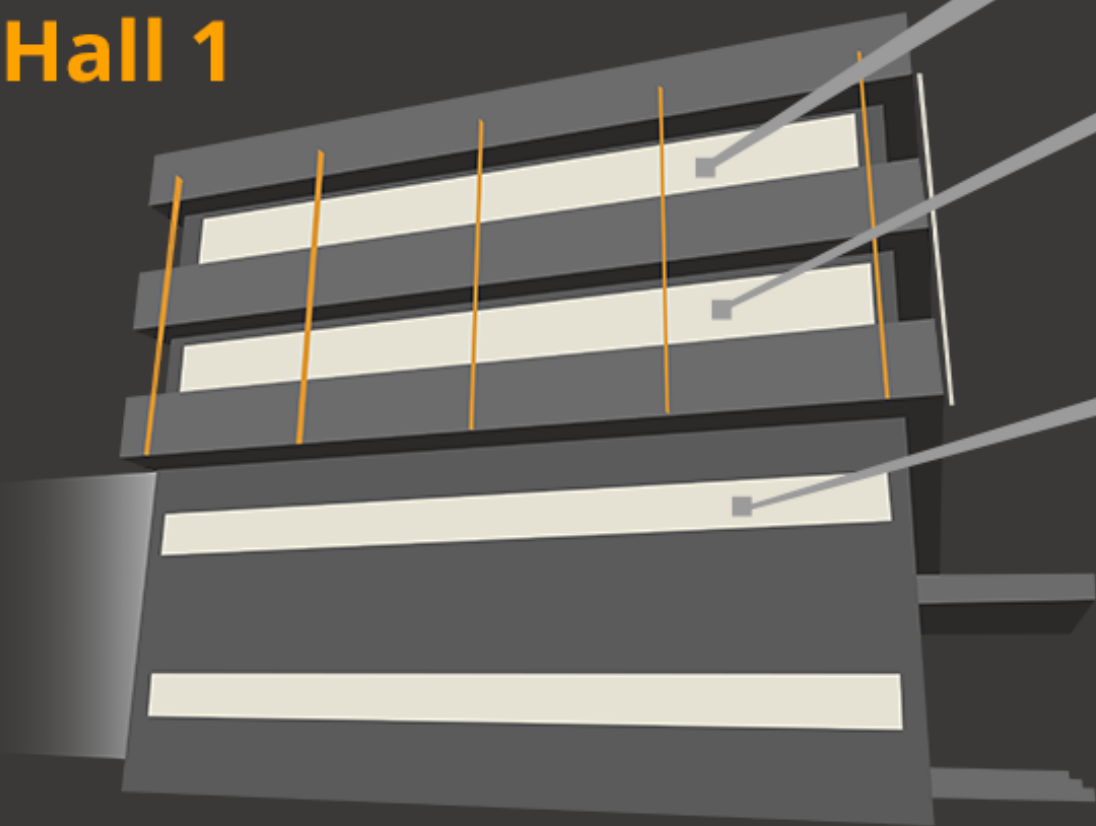

## 1. Floor

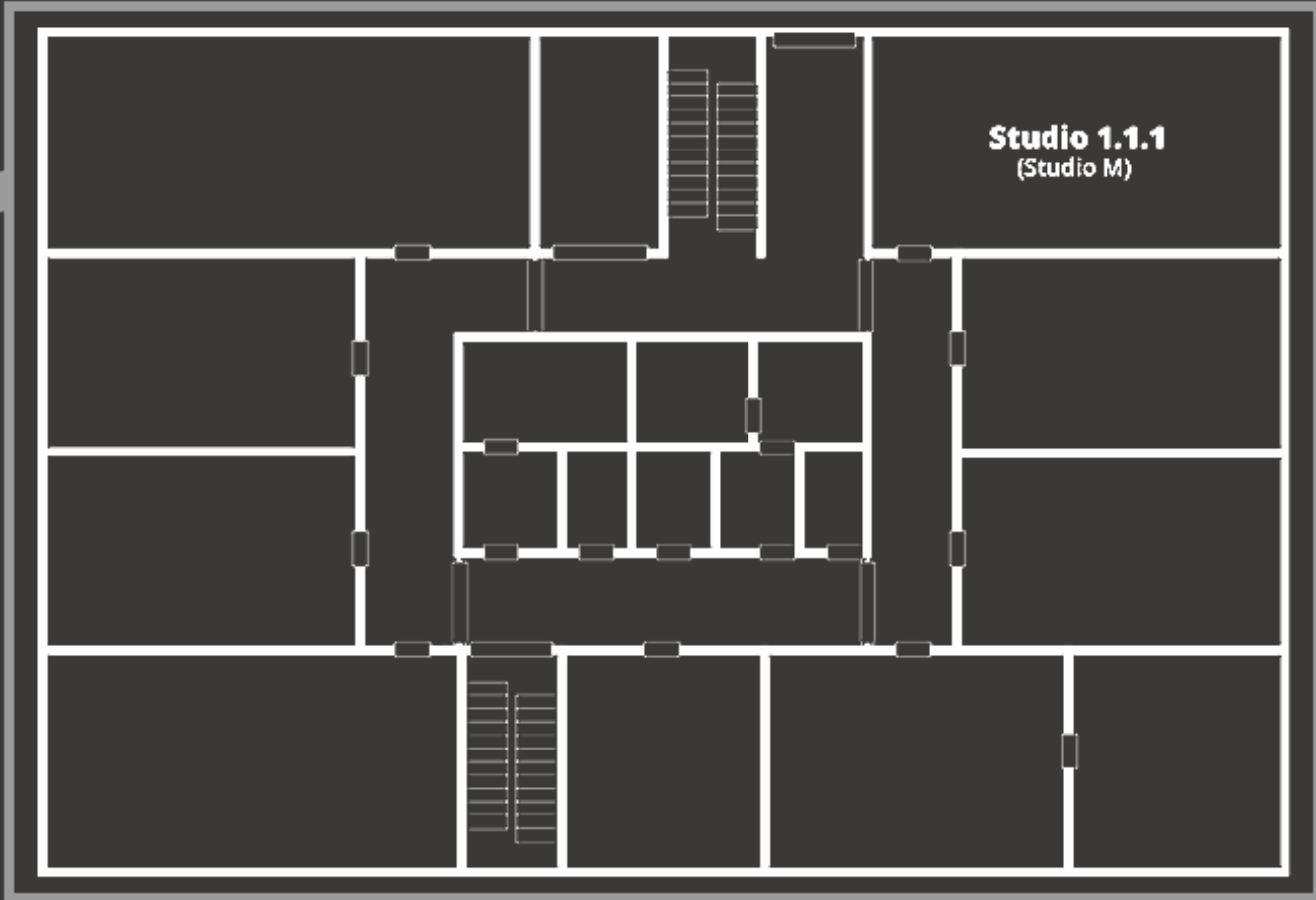





# STUDIO 1.2.1

Studio 1.2.1 is your go-to choice for broadcast productions. With its versatile features and professional-grade equipment, it's designed to meet your individual needs.

Studio Size: 9,80m x 9,55m | 81,05m<sup>2</sup> | Ceiling height of 2,5m

## FEATURES



professional  
audio



professional  
video



professional  
lighting



cooling system

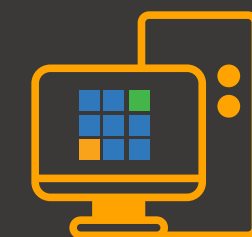

scalable Vmix  
Control Room



two separate  
areas



controlable  
by 1-10 crew



9m x 2m  
banner wall



8x horizontal  
monitor wall



customizable  
branding



OUR MIDDLE-SIZE ALL-ROUNDER





# STUDIO 1.3.1

Studio 1.3.1 offers a practical solution for budget-conscious productions without sacrificing quality. Customize it to your liking, harness professional-grade equipment, and take control of your production destiny.

Studio Size: 10m x 5,1m | 51m<sup>2</sup> | Ceiling height of 2,5m

## FEATURES



professional  
audio



professional  
video



professional  
lighting



cooling system

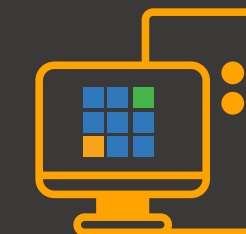

scalable Vmix  
Control Room



customizable  
interior



controlable  
by 1-3 crew



Budget-  
Friendly studio,  
high quality  
production





# WEBSTUDIOS

At Freaks 4U Gaming, we understand the importance of top-notch web studios in the world of streaming. That's why we offer not just one, but three state-of-the-art web studios to bring your creative ideas to life.

## FEATURES



professional  
audio



professional  
video



professional  
lighting



cooling system



green screens



two pc  
streaming setup



1-2 streamer



high  
performance pc



EVERYTHING IN ONE HAND





# ADDITIONAL SERVICES

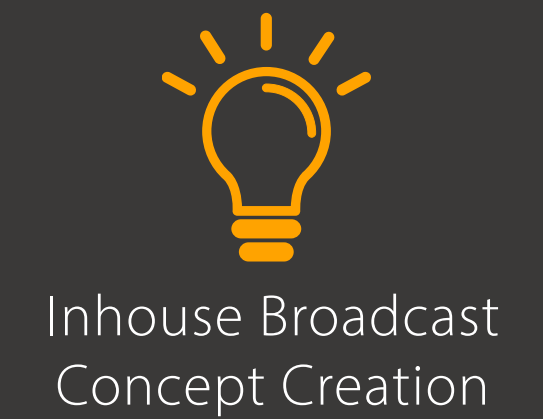
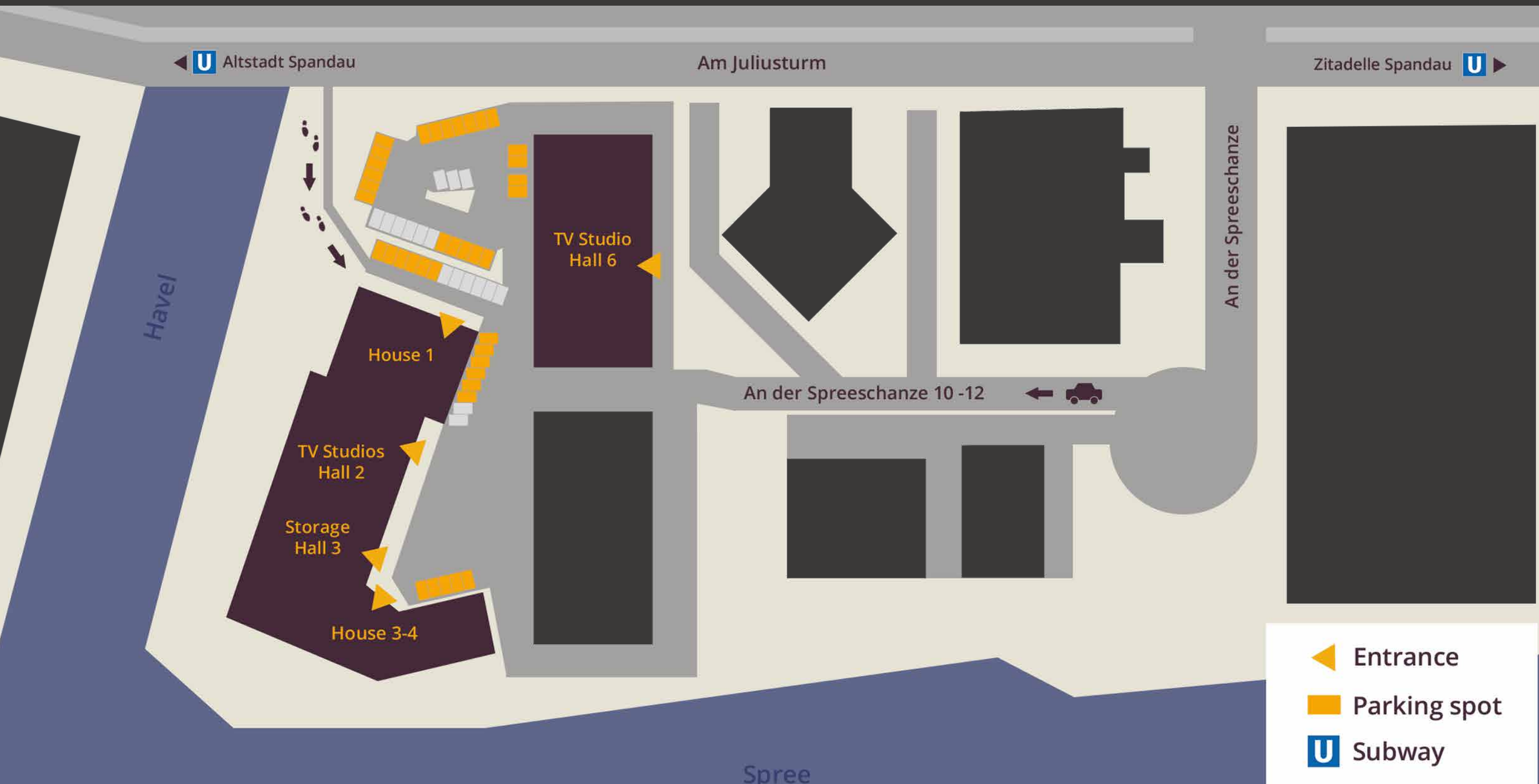











## CONNECTIONS

Parking lots  
Subway & bus connection: 5 min  
Highway: 15 min  
Airport: 45 min







# EQUIPMENT

## VIDEO EQUIPMENT

Video/Audio-Router (160x160 / 3072x3072)	12G SDI, 160 synchronized IN- & Out-puts, 3072x3072 Audio Routing, de- & em-bedding , MADI	
Video Router 40x40	12G SDI, 40 inputs, 40 outputs	
Multiviewer	96 inputs, 12 UHD outputs	
Vision Mixer	4 M/E, 2160p60, 40 inputs, 28 outputs, 4 x DVE, 16/4/16 Up/Down/Chroma -Keyers, 4x Stinger	
Mixer Panel	2 M/E Vision Mixer Panel, Macro Buttons, User Buttons	
Video Recording	2160p60, H.264, ProRes, DNx, 4:2:2 10bit	
Colour Accurate Monitor	2160p60 Waveform, Vector Scope, 3D Lut, HDR	
Monitor Wall	2160p60, 24/7 Perfomance, HDR	
Teleprompter	17" CSM, Talentmonitor, TimecodeDisplay	
LED Wall	8,9mm transparency / 1,8mm highres, modular frames	

## VIDEO CONVERSION/DISTRIBUTION

Video Standards Converter	2160p60 Broadcast Converter HDMI   SDI   DVI   DP	
Fiber Converter	bidrectional fiber converter 12G SDI, Singlemode	
A/D Audio Converter	64 Channel Audio Converter, Analog/Madi/Adat/Dante	
Video Distribution	1080p60 H264 Encoding reliable, Redundant, RTMP, IPTV	

The technology listed is our standard technology that we use. We have other systems we can integrate.







# EQUIPMENT

## CAMERA EQUIPMENT

Camera	4K 2160p60 Broadcast Cameras,Studio Viewfinder	
Lense	4K lenses (total 5.5mm-374mm) Zoom, Focus and Iris Servo	 
Pedestals	Crab-/Steer-mode, max payload 180kg/176.4lbs, 690mm-1460mm/27.2"-57.5"	 
Crane	1.20m-9m, Remote Head, Camera Control Cables, Dolly	
PTZ-Camera	4K 2016p60 PTZ Camera 20x Zoom, Wide Angle, Stabilizer	 
Facecams	1080p60, lense changeable, remote controllable	

## GRAPHIC AND VIDEO SOLUTIONS













Graphics Playout Server	2160p60, Keyframe Animations, DataLink, Live Inputs, 3D support, VideoClip Support	
Replay/Slomo (LSM)	up to 8 Channels, 2 User-Interfaces, 2160p60, 200Hours HD	 
Telestrator	Analyse & Telestrator Tool, Record & Replay Clips, Web & Touch Interface from tablet to 98" Screen	
Video Server & Visual Effect Software	2160p, Generating Video Display & Led Wall Output, Live Inputs	

The technology listed is our standard technology that we use. We have other systems we can integrate. Upgrading to an EVS is also possible but not included in the standard equipment





# EQUIPMENT

## AUDIO EQUIPMENT

Audio Mixer	Up to 128 I/O 96kHz ,Analog, MADI, AES, Dante	
Audio Mixer Panel	36 faders, 216 fader strips, 2 touchscreens, up to 128 I/O 96kHz, Analog, MADI, AES, Dante	 
Audio Compressor	Loudness Measurement, True Peak Limiter, ITU-R BS.1770, EBU R128	
Loudness Meter	16-Channel, AES, EBU R128, ITU BS.1770-4/1771-1	
Wireless Bodypack Transmitter	Pilot tone squelch, Signal-to-noise ratio ≥ 120 dBA	
Wireless Handheld Transmitter	Pilot tone squelch, Signal-to-noise ratio ≥ 120 dBA	
Headset Microphone	Round directional capsule, Two-Ear-Headset	 
In Ear Monitoring	custom ear mold, coiled acoustic tube (transparent material)	
Commentator console	Talkback, Cough, 4 Headphone channels	
Caster Headset	Circumaural, Closed, 128dB SPL at 1kHz, 8HZ - 18kHz, Microphone: 40Hz - 18kHz	 

## INTERCOM COMMUNICATION









Intercom Communication	Controller for max 1024x1024, 128 Interfaces scalable	
Wireless Communication	Beltpacks completely integrated into Intercom system	 

The technology listed is our standard technology that we use. We have other systems we can integrate.







# EQUIPMENT

## LIGHT AND STAGE

Fresnel Light	RGBW, PO, LED	 
Flood Light	RGBW, PO, LED	 
Moving Head Light	Wash, Spot, static & moving Bar	 
DMX Light Controlling	3x512 DMX Adresses, Network Connection	
Studio Control	Matrix & Routing Controller all systems, Information display host, Tally-Controller	

## NETWORK & INTERNET

Network	Full redundant, Switch-Fabric-Speed 2030 Gbit/s, supports SPP+, 40GbE-Connections	
Internet	Up to 10Gbit/s, 3 independent Connections	  
KVM Matrix	Scalable, FHD/4K, Single & Dual-Head, IP	

## POWER & UPS

Uninterruptible Power Supply	200kVA, EN 62040-3	
------------------------------	--------------------	---

The technology listed is our standard technology that we use. We have other systems we can integrate.





[www.freaks4u.de](http://www.freaks4u.de)

[TVproduction@freaks4u.de](mailto:TVproduction@freaks4u.de) or [newbusiness@freaks4u.de](mailto:newbusiness@freaks4u.de)

